



# Control<sup>®</sup> 42C

## 2.5" Ultra-Compact, In-Ceiling Satellite Loudspeaker

### Professional Series

### Key Features:

- ▶ Very broad 160° coverage pattern
- ▶ 60 mm (2.5 in) mid-high driver with butyl rubber surround
- ▶ 16-ohm driver, allows paralleling of multiple units on a low-Z amplifier
- ▶ Integrated backcan for easy "blind-mount" install. Packaged with grille and C-ring support backing plate for easy installation.

### Applications:

The Control 42C is an ultra-compact in-ceiling professional satellite loudspeaker designed for use with the Control 40CS/T subwoofer. When combined with the Control 40CS/T, the Control 42C offers an extremely natural sounding and powerful subwoofer-satellite system that is perfect for applications requiring wide bandwidth and superior sonic performance with minimal visual impact.

The integrated backcan on the Control 42C combined with the C-ring support backing plate allows for a quick and easy installation of the unit. The system's 60 mm (2.5 in) mid-high driver features a polypropylene cone and pure butyl-rubber surround for long life. The copper-clad aluminum voice coil wound on a vented aluminum former offers low distortion.

The 16-ohm impedance allows paralleling up to 4 speakers on a 4-ohm capable amplifier.

The Control 42C must be operated with either an active high-pass filter or a passive crossover, such as the one built into the Control 40CS/T subwoofer, to protect it against damage from low frequencies.

Because of the very light weight of Control 42C, tile rails may not be required for many in-ceiling applications. They are not packaged with this model, however MTC-RAIL tile rail sets are available separately.

Housed in a compact package, the lightweight Control 42C features an elegant, unobtrusive design and is ideal for both small and large projects alike.



### Specifications:

<b>System:</b>	
Frequency Range (-10 dB) <sup>1</sup> :	140 Hz - 20 kHz
Frequency Response (± 3 dB) <sup>1</sup> :	180 Hz - 17 kHz
Power Capacity <sup>2</sup> :	30 Watts Continuous Program Power 15 Watts Continuous Pink Noise
Nominal Sensitivity (2.83V/1m) <sup>1</sup> :	82 dB
Nominal Coverage Angle <sup>3</sup> :	160° conical coverage
Directivity Factor (Q) <sup>3</sup> :	6.6
Directivity Index (DI) <sup>3</sup> :	6.8 dB
Rated Maximum SPL:	94 dB @ 1 m (3.3 ft) average, 114 dB peak
Rated Impedance:	16 ohms
<b>Transducer:</b>	
Driver:	60 mm (2.5 in) with polypropylene cone, butyl rubber surround, copper-clad coil, vented aluminum former.
<b>Enclosure:</b>	
Input Connectors:	Two removeable locking 2-pin connectors with screw-down terminals. Max wire 12 AWG (2.5 mm).
Knockouts:	Two (top and side)
Safety Agency:	Designed for the requirements of use in air handling spaces per UL1480, UL2043, NFPA90, NFPA70A, and in accordance with the requirements of IEC60849/EN60849
Dimensions:	127 mm Diameter x 94 mm depth (5.0 in x 4.2 in) from back of baffle
Cutout Size:	104 mm Diameter (4.1 in)
Ceiling Thickness Range:	Accommodates tiles/drywall up to 27 mm (1.1 inches) thick
Weight:	0.7 kg (1.6 lb)
Included Accessories:	C-ring support backing plate, knockout strain relief, cutout template, paint shield.
Optional Accessories:	MTC-RAIL tile rails MTC-42NC New Construction bracket MTC-42MR Mud Ring Construction Bracket

<sup>1</sup> Half-space (flush mounted in ceiling)

<sup>2</sup> Continuous Pink Noise rating is IEC-shaped pink noise with a 6 dB crest factor for 100 hours continuously. Continuous Program power is a conservative expression of the system's ability to handle normal speech and music program material, and is defined as 3 dB above the Continuous Pink Noise Rating.

<sup>3</sup> Half-space (in ceiling) average 1 kHz to 16 kHz.

## ► Control 42C 2.5" Ultra Compact, In-Ceiling Satellite Loudspeaker

### Beamwidth:

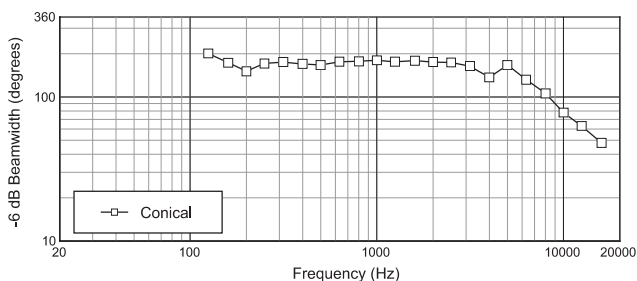

### Frequency Response:

Half-space ( $2\pi$ , mounted in ceiling)

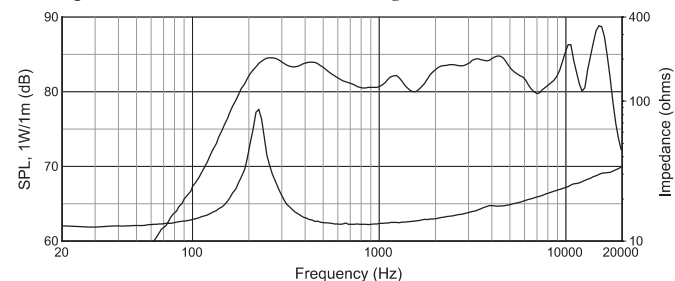

### Directivity Index:

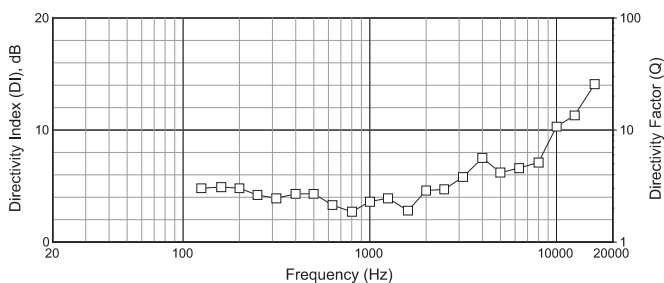

### Off-Axis Frequency Response:

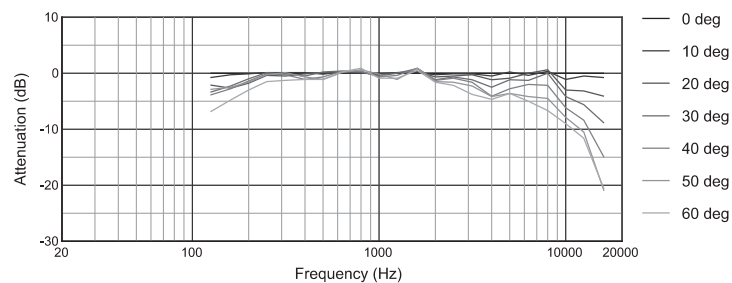

### Dimensions:

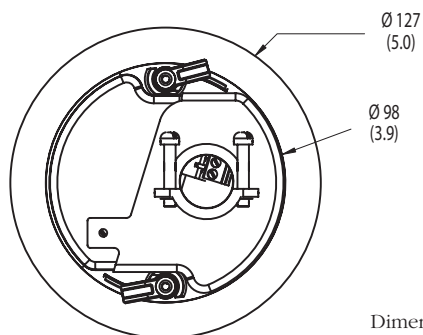
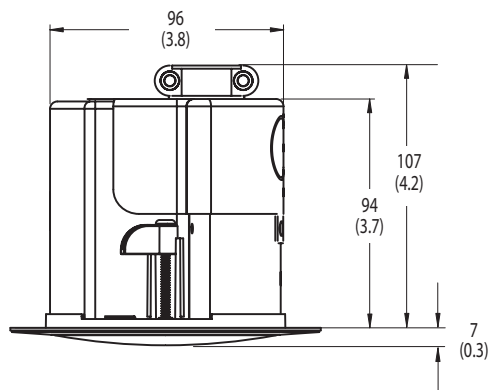

Dimensions in mm (in)



JBL Professional  
8500 Balboa Boulevard, P.O. Box 2200  
Northridge, California 91329 U.S.A.

© A Harman International Company  
© Copyright 2008 JBL Professional  
[www.jblpro.com](http://www.jblpro.com)

SS C42C  
CRP 5M  
09/08